

# FORM C - OBJECT

Assessor's number USGS Quad Area(s) Form Number

38/117/1

Billerica

925

MASSACHUSETTS HISTORICAL COMMISSION  
 MASSACHUSETTS ARCHIVES BUILDING  
 220 MORRISSEY BOULEVARD  
 BOSTON, MASSACHUSETTS 02125

Town Chelmsford

Place (neighborhood or village)  
 Chelmsford Veterans Memorial Park

Address or Location between 230 & 250 North Rd.

Name Contributors' Stone

Ownership  Public  Private

Type of Object (check one):

- statue
- bust
- group composition
- religious shrine
- boundary marker
- other (specify)
- monument
- milestone
- marker

Date of Construction

Source CVMP records

Designer/Sculptor Adrian Luz

Materials granite

Alterations (with dates)

Condition excellent

Moved  no  yes Date

Acreage 38.26 acres

Setting

lightly wooded, bounded by small stream, very busy North Rd. Former police station on south side, middle school on north side beyond small stream.

Recorded by Jane B. Drury

Organization for Chelmsford Historical Commission

Date (month/year) Oct. 2003

Photograph



## Sketch Map

Draw a map showing the object's location in relation to the nearest cross streets and/or major natural features. Show all buildings between object and nearest intersection or natural feature. Label streets and buildings if any. Circle and number

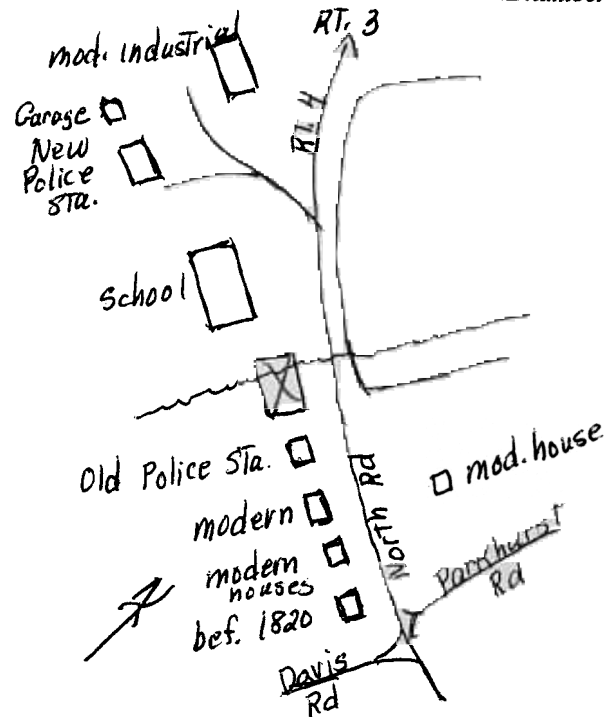

## OBJECT FORM

### DESIGN ASSESSMENT see continuation sheet

Describe the design features of the object, and evaluate in terms of other similar types of objects within the community.

This stone, 47" tall by 20" wide, is taller and narrower than most other monuments in Chelmsford

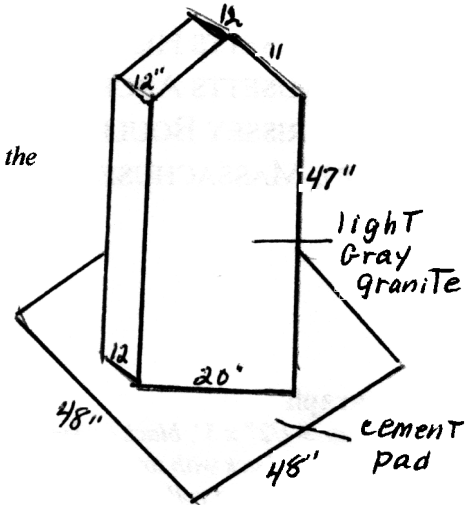

### HISTORICAL NARRATIVE see continuation sheet

Explain the history of the object, and how it relates to the development of the community

The Delaney family wanted donations to the park in Ruth's memory, in lieu of funeral flowers. The thus collected money was used to finish up payment for the soldier & boy stone. However, Betty's brother wanted Ruth's name used somewhere, so that others would get the idea to do the same. So, the committee put up the stone with her name, and since then other families have also contributed to the park, so their names have been added on to the Contributors stone.

### ENTIRE INSCRIPTION (if applicable).

IN APPRECIATION OF DONATIONS  
RECEIVED IN MEMORY OF  
THESE FRIENDS OF THE PARK:

RUTH DELANEY      VAL STONE  
PATRICK MURTRUGH      PAUL VILLARE

### BIBLIOGRAPHY and/or REFERENCES see continuation sheet

Elizabeth Delaney, Jan. 21, 2003

Recommended for listing in National Register of Historic Places. If checked, you must attach a completed National Register Criteria Statement form.



'Contributors' Stone' Veterans Memorial

9/4/2004 F Merriam