

FORM B - BUILDING SURVEY

80

MASSACHUSETTS HISTORICAL COMMISSION  
Office of the Secretary, State House, Boston

1. Is this building historically significant to:  
Town Commonwealth Nation

Building has historical connection with the following themes: (see also reverse side)

- |               |                      |
|---------------|----------------------|
| Scholar       | Commerce/industry    |
| Agriculture   | Science/invention    |
| Art/Sculpture | Travel/communication |
| Education     | Military Affairs     |
| Government    | Religion/philosophy  |
| Literature    | Indians              |
| Music         | Other _____          |

Development of town/city

Architectural reason for inventorying:

2. Town NORTH CHELMSFORD

Street address 100 DUNSTABLE RD.

Name Blodgett House

Use: original & present RESIDENCE

Present owner JOHN AVILA

Open to public No

Date 1853-1868 Style Greek Revival

Source of date Deed Books

Architect \_\_\_\_\_

OR part of Area # \_\_\_\_\_

3. CONDITION Excellent Good Fair Deteriorated Moved Altered Added \_\_\_\_\_

4. DESCRIPTION

FOUNDATION/BASEMENT: High Regular Low Material FIELD STONE

WALL COVER: Wood CLAPBOARD Brick Stone Other \_\_\_\_\_

ROOF: Ridge Gambrel Flat Hip Mansard \_\_\_\_\_  
Tower Cupola Dormer windows Balustrade Grillwork ON THE ELL

CHIMNEYS: 1 2 3 4 Center End Interior Irregular Cluster Elaborate

STORIES: 1 2 3 4 ATTACHMENTS: Wings Ell Shed ONE DORMER - 1/2 story

PORCHES: 1 2 3 4 \_\_\_\_\_ PORTICO \_\_\_\_\_ Balcony

FACADE: Gable end: Front/side Ornament \_\_\_\_\_

Entrance: Side Front: Center/Side Details: PANEL DOOR; FOUR LIGHTS EACH SIDE

Windows: Spacing: Regular/Irregular Identical/Varied 3 BAY X 2 BAY; 6 OVER 6; FRONT & REAR 1ST FLOOR ARE 78" X 29"; DIAMOND SHAPED ON ELL.

Corners: Plain Pilasters Quoins Cornerboards ON ELL

5. Indicate location of building in relation to nearest cross streets and other buildings

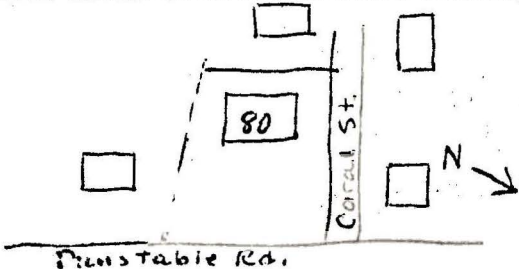

6. Footage of structure from street 100'  
Property has 150' feet frontage on street

Recorder Norma Laas Thompson

For Chelmsford Historical Society Commission

Photo # 8-10A Date 5/24/73

SEE REVERSE SIDE

2. Landscape Features: Agriculture Open Wooded Garden: Formal/Informal

Predominant features \_\_\_\_\_

Landscape architect \_\_\_\_\_

3. Neighboring Structures

Style: Colonial Federal Greek Revival Gothic Revival Italian Villa Lombard Rom.  
Venetian Gothic Mansard Richardsonian Modern

Use: Residential Commercial Religious Conditions: Excellent Good Fair Deteriorated

-----  
GIVE A BRIEF DESCRIPTION OF HISTORIC IMPORTANCE OF SITE (Refer and elaborate on theme circled on front of form)

The Blodgett's were among the first settlers of North Chelmsford. Frederick W. Blodgett is listed as one of the original subscribers to the North Chelmsford Library Fund in Rev. Waters' "History of Chelmsford."

At one end, the brick chimney is visible through the attic window. It seems inches away from the window as seen from outside.

BIBLIOGRAPHY AND/OR REFERENCE

Waters "History of Chelmsford, Mass." (1917)  
Beers Atlas - 1875

RESTRICTIONS \_\_\_\_\_

Original Owner: Frederick W. Blodgett (Blodget)

Deed Information: \* Book Number 18 Page 220, Northern Registry of Deeds

\* Purchase of land, April 12, 1853

House is mentioned - Book 66 p 551, Sept. 10, 1868.

Irene Littlefield to John Avila

1/11/1960

Sara B. Walsh to Percy T. Robinson et ux

11/26/1926

Book 745, p. 251

Napoleon Coupal & Mary A. Coupal to Sarah B. Walsh

12/14/1925

Book 731, p. 478

Ruth G. Robinson to N. Coupal

Sarah B. Walsh to Ruth G. Robinson, wife of Percy T. Robinson

1/1/1921

5/2/1921

Joseph S. Blodgett, Nellie F. Stevens, Frederick A. Davis,  
Hattie May Saville to Sarah B. Walsh

3/ /1917

5/2/1917

Book 571, p. 412

Samuel A. & Sarah E. Waters to Betsy B. Blodgett

4/25/1868

4/27/1868

Book 61, p. 348

Betsy B. Blodgett, wife of Frederick W. to Samuel A. &  
Sarah E. Waters

4/27/1868

Book 61, p. 358

Frederick W. Blodgett to Samuel A. Waters

9/10/1868

4/23/1869

Book 66, p. 551

Elijah M. Reed to Frederick W. Blodgett

4/12/1853

5/24/1853

Book 18, p. 220

Sarah H. Dunn & Henry C. Dunn to Elijah M. Read

3/23/1853

Book 18, p. 263

Simeon Blodgett to Simeon Blodgett Dunn

11/13/1844

1/24/1849

Book 16, p. 530







