

FORM B - BUILDING

MASSACHUSETTS HISTORICAL COMMISSION
Office of the Secretary, State House, Boston

In Area no.	Form no.
	261



1. Town Chelmsford
 Address 55 Billerica Rd.
 Name Bean House
 Present use 1 family dwelling
 Present owner David E. Besonen

3. Description:
 Date 1887-8
 Source Lowell Weekly Journal

Style _____
 Architect Jonathan Larcom
 Exterior wall fabric clapboard
 Outbuildings (describe) _____
 Other features paired brackets under eaves & front entrance hood; also topping the plain cornerboards

Altered see attached Date _____
 Moved no Date _____

5. Lot size:
18,185 sq. ft.
 One acre or less x Over one acre
 Approximate frontage 100 feet
 Approximate distance of building from street
ca 50 feet

6. Recorded by Jane B. Drury
 Organization Chelmsford Hist. Commission
 Date November 17, 1979

4. Map. Draw sketch of building location in relation to nearest cross streets and other buildings. Indicate north.

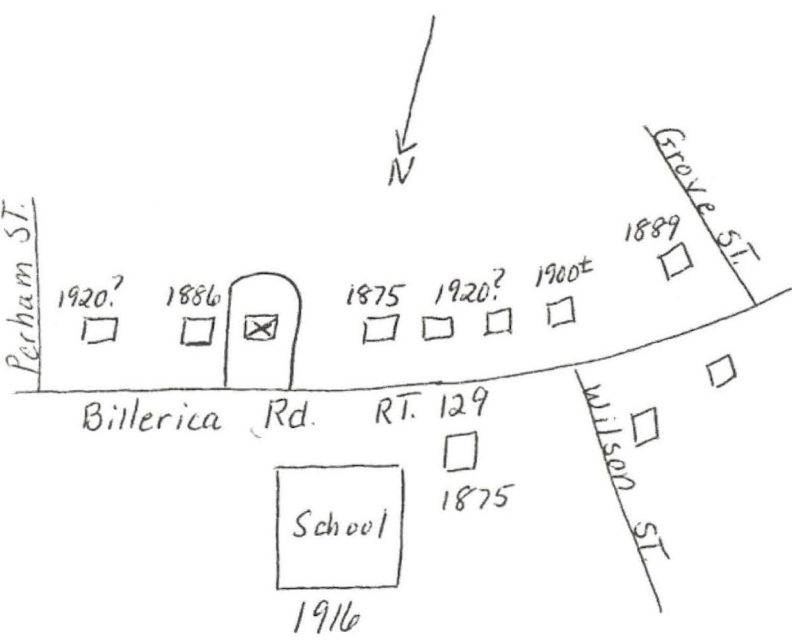

DO NOT WRITE IN THIS SPACE
 USGS Quadrant _____
 MHC Photo no. _____

(over)

7. Original owner (if known) Isaac Woodward Brown (d. 1916)

Original use dwelling

Subsequent uses (if any) and dates _____

8. Themes (check as many as applicable)

Aboriginal	_____	Conservation	_____	Recreation
Agricultural	_____	Education	_____	Religion
Architectural	_____	Exploration/ settlement	_____	Science/ invention
The Arts	_____	Industry	_____	Social/ humanitarian
Commerce	_____	Military	_____	Transportation
Communication	_____	Political	_____	
Community development	<u>x</u>			

9. Historical significance (include explanation of themes checked above)

In August 1887 Almon W. Holt was hired to erect this house for I. Woodward Brown, but in November 7 of the same year it was being built by Jonathan Larcom. Mr. Larcom was also an architect, so it is likely that he also designed the house.

I.W. Brown came from Lowell to Chelmsford, where he was a farmer. However, in 1899 he returned to Lowell with his second wife and worked there first as a syrup maker then as a salesman until his death in 1916. The house remained in his widow's family, the Beans, until 1974.

10. Bibliography and/or references (such as local histories, deeds, assessor's records, early maps, etc.)

1889 Atlas, 1875 Beers Atlas

Plan Book M, Plan 97 (1915)

Middlesex North Dist. Reg. Deeds: Bk. 191, pg. 274 (1887)

Chelmsford Assessors, Building Inspector, Town Clerk's records

Lowell Weekly Journal: Aug. 26, 1887; Nov. 7, 1887

Waters, History of Chelmsford, pg. 726

Chelmsford & Lowell Street Directories

Joanne Besonen, 1979 owner

INVENTORY FORM CONTINUATION SHEET

MASSACHUSETTS HISTORICAL COMMISSION
Office of the Secretary, Boston

Community: Chelmsford	Form No: 261
Property Name: <i>Bean House</i>	

Indicate each item on inventory form which is being continued below

3. Alterations:

1889 Atlas

Revaluation Card
June 4, 1971

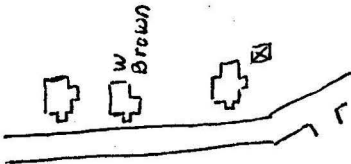

Plan Book M, Plan 97
1915

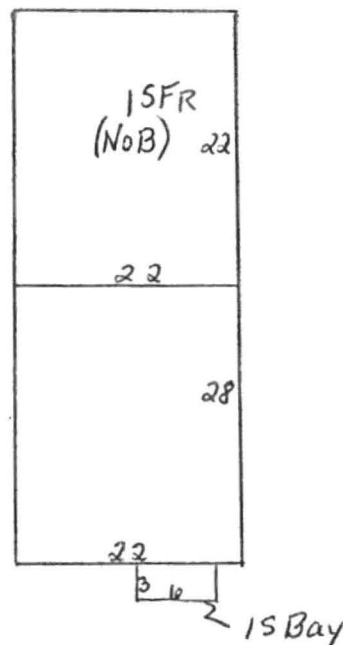

The present owners were told of a fire about 1960 in the ell (rear of house). This may be the reason for \$2000 worth of interior remodelling (plus 3 exterior windows) in 1959. The right rear (ell) of the house appears to be of modern construction with cinderblock foundation.

Staple to Inventory form at bottom

55 Billerica Road
Middlesex North District Registry of Deeds

Bk. 2300, pg. 283	5/ 3/1978	Lillian M. Bean to David E. & Joanne F. Besonen \$37,500 land & buildings - portion Lot 5
Bk. 2109, pg. 123	4/30/1974	Est. Kenneth P. Bean to Lillian M. Bean \$1.00 land & buildings - portion Lot 5
Bk. 1342, pg. 434	7/17/1956	Est. Isaac Woodward Brown, Lowell, to Donald P. Bean less than \$100 36,451 sq. ft. land
Bk. 564, pg. 321	7/27/1916	I. Woodward Brown, Lowell, to Mary E. Brown, wife Land - portion Lot 5
Bk. 191, pg. 274	8/26/1887	David Harding, Lowell, to Lydia M. Brown, wife of I. Woodward Brown \$364.67 land - 36451 sq. ft., Lot 5
Bk. 94, pg. 437	6/13/1873	David Perham to David Harding, Lowell \$397.67 1. lot 2 - 28719 sq. ft. 2. lot 5 - 36451 sq. ft.
Bk. 88, pg. 91	7/17/1872	Ephraim B. Patch, Lowell, to David Perham \$2000 21 acres & 83 sq. rods land reserved: 1. right of way over westerly portion to wood lot. 2. occupation by Andrew J. Park until Aug. 1, 1872
Bk. 86, pg. 480	6/29/1872	Andrew H. & Sarah Y. Park to Ephraim B. Patch, Lowell



7/25/2004 F. Merriam